

# LEARNED

COMMERCIAL, INC.

Providing Select Commercial Real Estate Services



## For Lease

**1600 Continental Place  
Mount Vernon, WA**

- 8,100+/- sf medical office/ office space [can be divided to 1,500+/- and up]
- 12,400+/- sf building built 2005
- Located just off College Way near controlled intersection
- Adjacent to Northwest Orthopedic Surgeons and Northwest Eye Surgeons
- In growing “annex” area to Skagit Valley Hospital with direct access to I-5 exit 227
- \$12 psf NNN



**CLAY LEARNED**

108 Gilkey Road, Burlington, WA 98233  
ph: 360-757-3888      fx: 360-757-1850  
[www.claylearned.com](http://www.claylearned.com)

*All info deemed reliable however verification recommended*

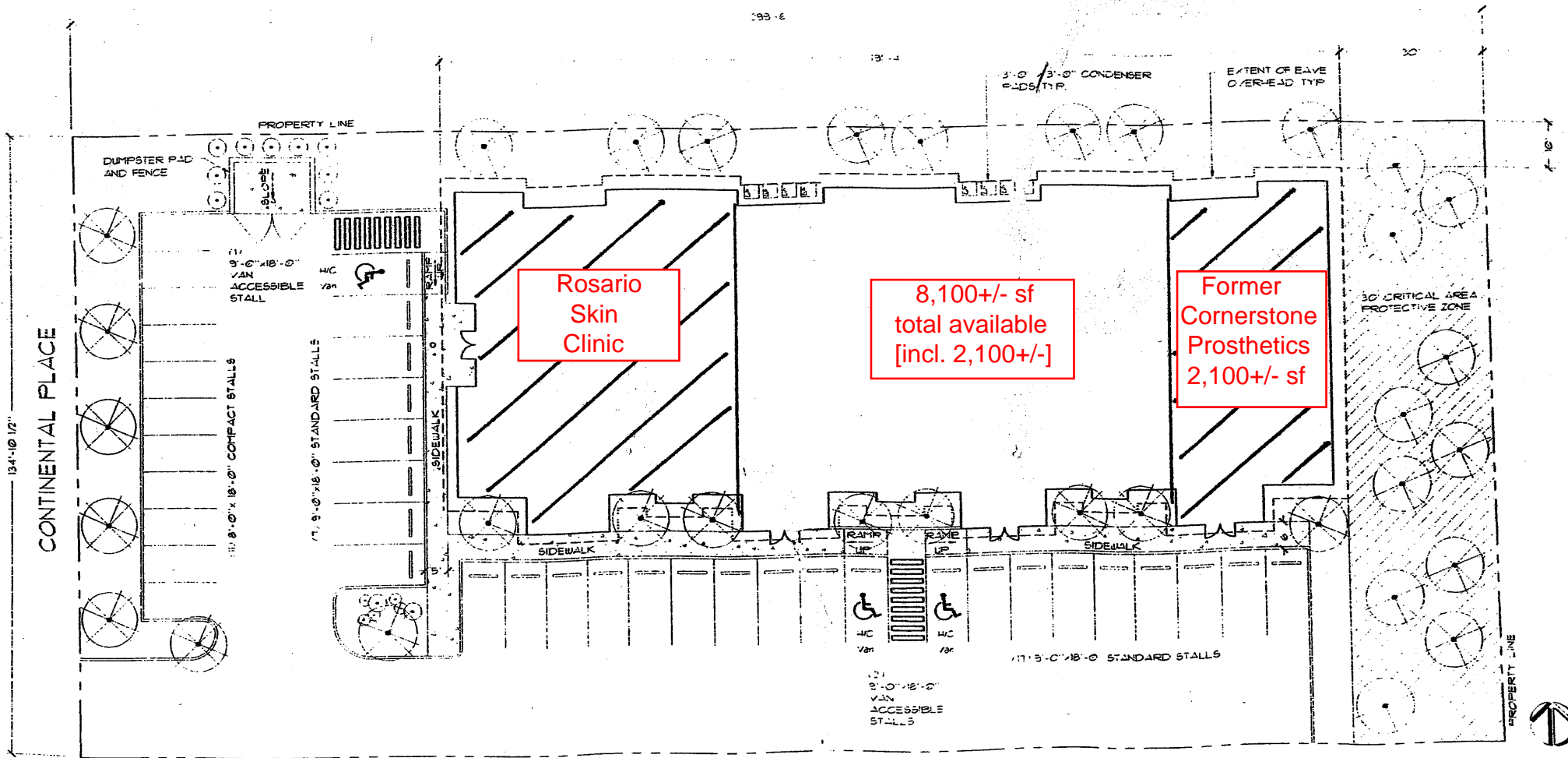

**1600 CONTINENTAL PLACE  
MOUNT VERNON, WA**

**\*\*NOT TO SCALE\*\***



EAST COLLEGE WAY

LEIGH WAY

CONTINENTAL PLACE

ROOSEVELT

AVENUE

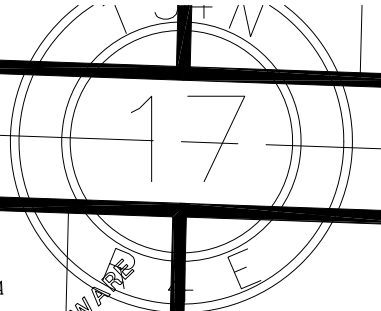

PLAT OF WAIVER  
4513

3  
P114423  
S/P MV-5-88  
8021  
BINDING SITE PLAN  
MV 1-00  
P114427

BSP MV-02-001  
8051  
S/P MV 8-77

S/P MV-4-84

REPLAT OF  
PARKER BUSI  
P80397  
AF2006

JRVEY  
200204150118  
1

P25976

304150165  
2

P109233

66

65

64

63

62

# MOUNT VERNON RETAIL CORE

1. I-5 Exit 227
2. College Way/Hwy 538
3. Riverside Drive
4. Burlington Northern/  
Santa Fe RR
5. **Mount Vernon Center**  
Northwest Multiple  
Listing Service  
Dept of Labor &  
Industries  
Value Village  
Urban Fitness  
Aaron Rents  
& Others
6. El Gitano Restaurant
7. JoAnn Fabrics  
Century 21
8. **Skagit Valley Square**  
Rite Aid  
Rent-A-Center  
Hallmark  
Dollar Tree  
Denney's  
Wells Fargo Bank  
Jack-in-the-Box
9. Goodwill  
Woodmonsters  
The Learning Ladder
10. Office Depot  
Petco  
Frontier Bank  
Round Table Pizza  
Taco Time/Pizza Hut
11. Safeway/Safeway Gas  
Subway  
People's Bank  
Blockbuster  
Schuck's/O'Reilly's
12. Super Wal Mart
13. Best Western  
Cottontree Inn &  
Convention Center
14. Lowe's
15. Blade Chevrolet & RV  
Center
16. Old Downtown



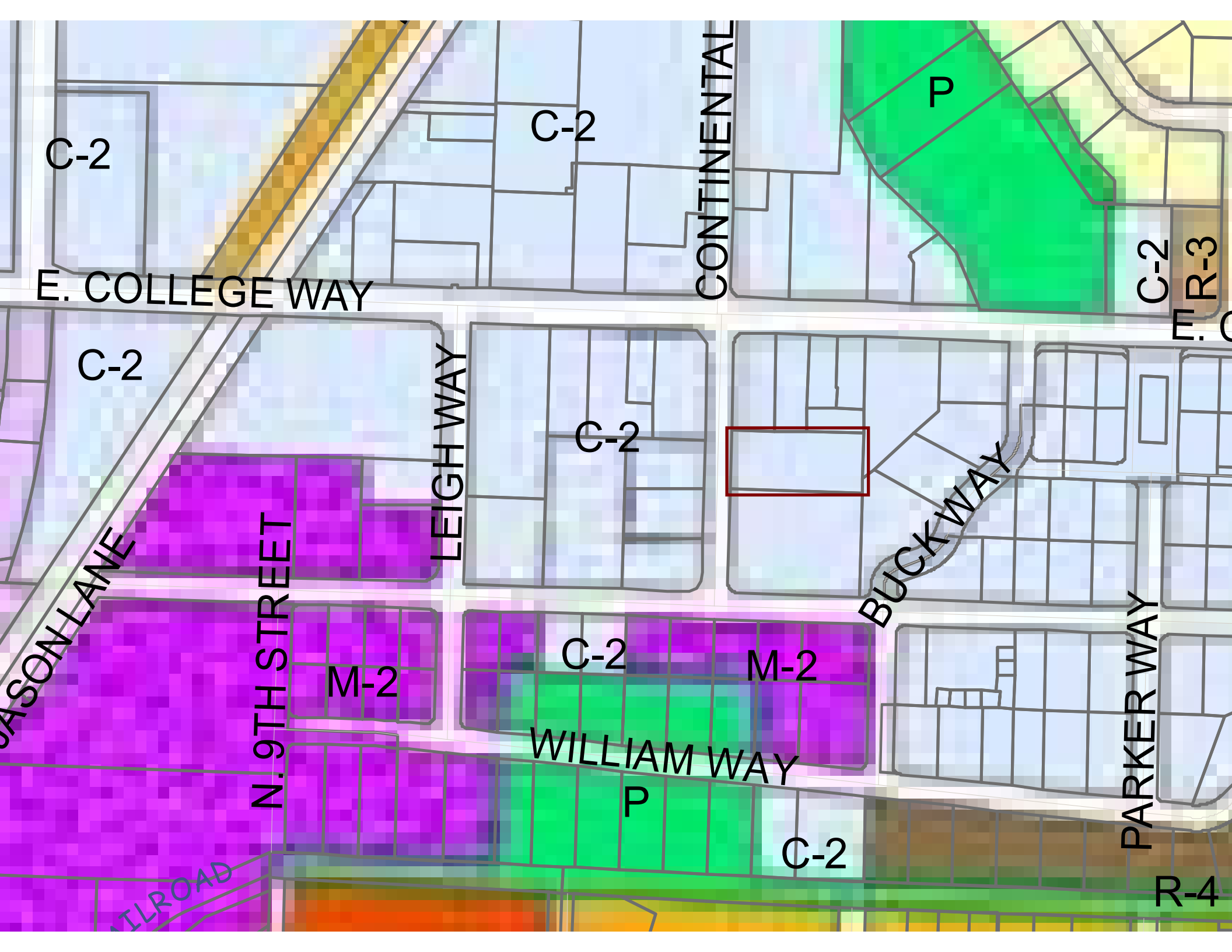

C-2

C-2

P

C-2

R-3

E. COLLEGE WAY

CONTINENTAL

C-2

C-2

LEIGH WAY

BUCK WAY

JASON LANE

N. 9TH STREET

M-2

C-2

M-2

WILLIAM WAY

P

C-2

PARKER WAY

R-4

RAILROAD

**Chapter 17.48**  
**C-2 GENERAL COMMERCIAL DISTRICT**

Sections:

17.48.010	Intent.
17.48.020	Permitted uses.
17.48.025	Accessory uses.
17.48.030	Prohibited uses.
17.48.040	Conditional uses.
17.48.050	Lot area and width.
17.48.060	Setbacks.
17.48.070	Building height.
17.48.080	Landscaping.
17.48.090	Parking.
17.48.100	Signs.
17.48.110	Site plan review.

**17.48.010 Intent.**

The intent of this chapter is to establish and preserve general commercial areas having a variety of uses and accessible primarily by automobile. (Ord. 3315, 2006; Ord. 2352, 1989).

**17.48.020 Permitted uses.**

Permitted primary uses in the C-2 district are as follows:

- A. Commercial uses:
1. Retail stores;
  2. Personal services;
  3. Offices, banks, and financial institutions;
  4. Hotels, motels and lodging houses;
  5. Eating and drinking establishments;
  6. Theaters, bowling alleys, skating rinks and other entertainment uses;
  7. Laundry and dry cleaning pickup stations;
  8. Outside sales of vehicles, boats, mobile homes or equipment;
  9. Drive-in banks and eating establishments;
  10. Gasoline service stations and automobile repair garages;
  11. Adult entertainment establishments, as herein defined; provided, that no adult entertainment establishment shall be located nearer than 1,000 feet from any other adult entertainment establishment; and provided further, that no adult entertainment establishment shall be located nearer than 1,000 feet from any public or private school, church, or public park. Distances as provided in this subsection shall be measured by following a straight line, without regard to intervening buildings, from the nearest point of the property parcel upon which the proposed use is to be located to the nearest point of the parcel of property of the land use from which the proposed use is to be separated; and,
  12. Day nurseries.

- B. Public and quasi-public uses:
  1. Governmental buildings, including fire and police stations and administrative offices; and,
  2. Museums, art galleries, libraries, clubs or fraternal societies and memorial buildings.
- C. Other uses specifically permitted:
  1. Printing operations;
  2. Upholstery and furniture repair shops;
- D. On-site hazardous waste treatment and storage facilities as an accessory use to a permitted use provided such facilities comply with the State Hazardous Waste Siting Standards and Mount Vernon and State Environmental Policy Act requirements;
- E. Emergency shelter for the homeless; provided, an emergency shelter for the homeless shall not be located within a 1,000-foot radius of any other emergency shelter for the homeless and an existing shelter shall not expand the existing square footage of their facility to accommodate the homeless, except that the Hearing Examiner may approve a location within a lesser distance or an increase in square footage of the existing facility to serve additional homeless if the applicant can demonstrate that such location will not be materially detrimental to neighboring properties due to excessive noise, lighting, or other interference with the peaceful use and possession of said neighboring properties; and provided further, an emergency shelter for the homeless shall have 100 square feet of gross floor area per resident as defined by the City Building Code (MVMC Title 15); and provided further, an emergency shelter for the homeless shall have any and all licenses as required by state and local law;
- F. Expansion of Existing Mini-Storage Facilities. Proposed new mini-storage facilities when adjacent to existing mini-storage facilities under the same ownership. (Ord. 3315, 2006; Ord. 3193 § 20, 2004; Ord. 3167 § 2, 2004; Ord. 3015 § 8, 2000; Ord. 2688, 1995; Ord. 2631 § 3, 1994; Ord. 2598 § 5, 1994; Ord. 2594 § 2, 1994; Ord. 2531 § 14, 1993; Ord. 2352, 1989).

**17.48.025 Accessory uses.**

Permitted accessory uses in the C-2 district include:

- A. Residence for watchman, custodian, manager or property owner of permitted use provided it is located within the same building as the principal use;
- B. Each primary building or structure is permitted to have one accessory building, which is exempt from building permit requirements, by definition of the International Building Code (120 square feet or less). These exempt structures are required to be located in the rear yard and maintain a minimum of five-foot setback from any other building or property line;
- C. Mini-storage facilities; and,
- D. Commercial or public parking garages and/or commercial or public surface parking.
- E. Card Room.  
(Ord. 3315, 2006; Ord. 3193 § 21, 2004; Ord. 3015 § 10, 2000; Ord. 3014 § 11, 2000; Ord. 2644 § 2, 1995).

**17.48.030 Prohibited uses.**

Uses specifically prohibited in the C-2 district are:

- A. Sales of inoperable vehicles or used parts;
- B. Junkyards;
- C. Auto wrecking yards. (Ord. 3315, 2006; Ord. 2352, 1989).

**17.48.040 Conditional uses.**

Uses permitted by conditional use permit, and classified as a Type III permit in the C-2 district, are as follows:

- A. Recreational vehicle parks subject to the following requirements:
  - 1. Each proposed recreational vehicle park shall be designed in accordance with Chapter 17.39 MVMC except that lot sizes shall be a minimum of 1,500 square feet, outside storage is not required and pedestrian walkways are not required.
- B. Restricted limited manufacturing uses involving the processing or fabrication of commodities or products subject to all the following restrictions, development and performance standards:
  - 1. All manufacturing activities including storage and warehousing shall be confined to enclosed buildings on the property.
  - 2. The use does not inflict upon the surrounding permitted land uses in the district smoke, dirt, glare, odors, vibration, noise, excessive hazards or water pollution detrimental to the health, welfare, or safety of the public occupying or visiting such areas.
  - 3. The design of all buildings and related improvements shall employ design standards to support and maintain the commercial character of the area.
- C. Churches; provided, that their principal access is from a collector street or greater and they shall conform to all the development standards and requirements of the public (P) zone and concurrent with approval the City shall require both the Comprehensive Plan and zoning designations to be changed to public (P) during the City's next Comprehensive Plan amendment cycle. (Ord. 3327 § 3, 2006).

**17.48.050 Lot area and width.**

There are no limitations on lot area and width. (Ord. 3315, 2006; Ord. 2352, 1989).

**17.48.060 Setbacks.**

Minimum setback requirements in the C-2 district are as follows:

- A. Front yard: 10 feet. Buildings on corner lots and through lots shall observe the minimum setback on both streets. For properties that front on an arterial the minimum setback from the right-of-way shall be 25 feet. The Community & Economic Development and Public Works Directors can through a Type I decision process administratively reduce, for good cause shown, this setback.
- B. Side yard and rear yard: none, except along any property line adjoining a residentially zoned district, with no intervening street or alley, there shall be a setback of at least five feet.

**17.48.070 Building height.**

Building height in the C-2 district is unrestricted except for fire safety considerations, and building code considerations. (Ord. 3315, 2006; Ord. 3072 § 10, 2001).

**17.48.080 Landscaping.**

Landscaping shall be required pursuant to the terms of Chapter 17.93 MVMC. (Ord. 3315, 2006; Ord. 2352, 1989).

**17.48.090 Parking.**

Parking shall be provided pursuant to the terms of Chapter 17.84 MVMC. (Ord. 3315, 2006; Ord. 2352, 1989).

**17.48.100 Signs.**

Signs shall meet the requirements as provided in Chapter 17.87 MVMC. (Ord. 3315, 2006; Ord. 2352, 1989).

**17.48.110 Site plan review.**

All developments in this district shall be subject to site plan review as provided in Chapter 17.90 MVMC. (Ord. 3315, 2006; Ord. 2352, 1989).



# Traffic Count Map

1600 Continental  
1600 Continental Pl, Mount Vernon, WA, 98273  
Ring: 5, 10, 15 Miles

Prepared by Marshall Learned  
Latitude: 48.434833  
Longitude: -122.325663

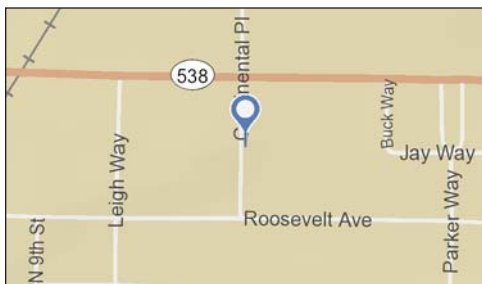
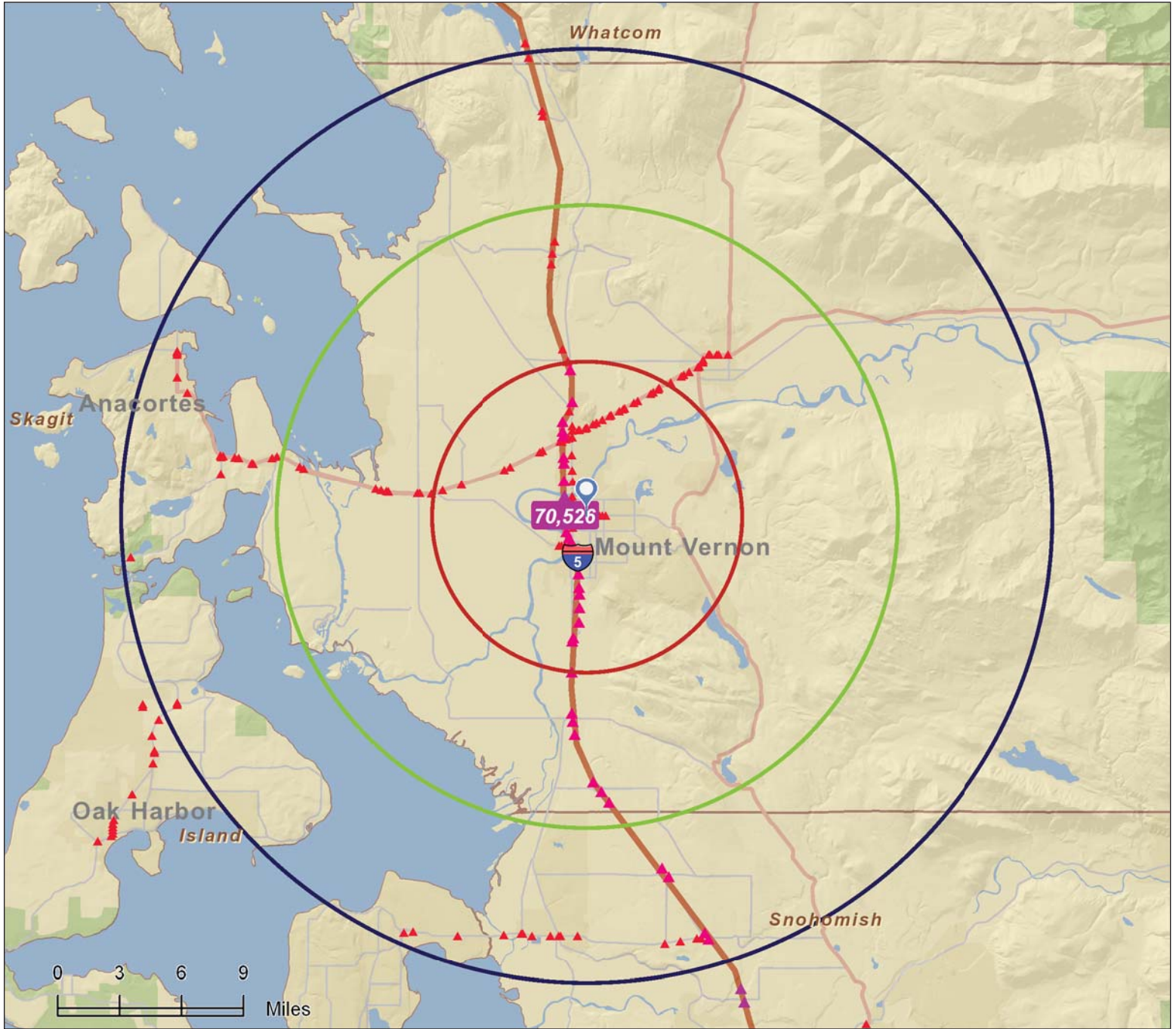

- Average Daily Traffic Volume**
- ▲ Up to 6,000 vehicles per day
  - ▲ 6,001 - 15,000
  - ▲ 15,001 - 30,000
  - ▲ 30,001 - 50,000
  - ▲ 50,001 - 100,000
  - ▲ More than 100,000 per day





# Executive Summary

Prepared by Marshall Learned

**1600 Continental**  
**1600 Continental Pl, Mount Vernon, WA, 98273**  
**Ring: 5, 10, 15 Miles**

**Latitude: 48.434833**  
**Longitude: -122.325663**

	5 miles radius	10 miles radius	15 miles radius
<b>2010 Population</b>			
Total Population	55,116	84,818	127,809
Male Population	49.7%	49.6%	49.6%
Female Population	50.3%	50.4%	50.4%
Median Age	34.1	36.4	38.9
<b>2010 Income</b>			
Median HH Income	\$53,031	\$53,015	\$55,588
Per Capita Income	\$22,673	\$23,238	\$24,627
Average HH Income	\$62,629	\$62,812	\$65,148
<b>2010 Households</b>			
Total Households	19,651	30,737	47,658
Average Household Size	2.75	2.71	2.64
<b>2010 Housing</b>			
Owner Occupied Housing Units	60.2%	62.4%	63.3%
Renter Occupied Housing Units	34.4%	30.9%	28.3%
Vacant Housing Units	5.4%	6.7%	8.4%
<b>Population</b>			
1990 Population	34,131	54,762	85,460
2000 Population	46,337	71,699	108,935
2010 Population	55,116	84,818	127,809
2015 Population	58,644	90,112	135,501
1990-2000 Annual Rate	3.1%	2.73%	2.46%
2000-2010 Annual Rate	1.71%	1.65%	1.57%
2010-2015 Annual Rate	1.25%	1.22%	1.18%

In the identified market area, the current year population is 127,809. In 2000, the Census count in the market area was 108,935. The rate of change since 2000 was 1.57 percent annually. The five-year projection for the population in the market area is 135,501, representing a change of 1.18 percent annually from 2010 to 2015. Currently, the population is 49.6 percent male and 50.4 percent female.

<b>Households</b>			
1990 Households	13,193	20,746	32,426
2000 Households	16,765	26,182	40,701
2010 Households	19,651	30,737	47,658
2015 Households	20,880	32,636	50,522
1990-2000 Annual Rate	2.43%	2.35%	2.3%
2000-2010 Annual Rate	1.56%	1.58%	1.55%
2010-2015 Annual Rate	1.22%	1.21%	1.17%

The household count in this market area has changed from 40,701 in 2000 to 47,658 in the current year, a change of 1.55 percent annually. The five-year projection of households is 50,522, a change of 1.17 percent annually from the current year total. Average household size is currently 2.64, compared to 2.63 in the year 2000. The number of families in the current year is 33,338 in the market area.

## Housing

Currently, 63.3 percent of the 52,015 housing units in the market area are owner occupied; 28.3 percent, renter occupied; and 8.4 percent are vacant. In 2000, there were 43,920 housing units - 64.5 percent owner occupied, 28.2 percent renter occupied and 7.3 percent vacant. The rate of change in housing units since 2000 is 1.66 percent. Median home value in the market area is \$262,596, compared to a median home value of \$157,913 for the U.S. In five years, median home value is projected to change by 4.61 percent annually to \$328,951. From 2000 to the current year, median home value changed by 5.13 percent annually.

Source: U.S. Bureau of the Census, 2000 Census of Population and Housing. Esri forecasts for 2010 and 2015. Esri converted 1990 Census data into 2000 geography.



# Executive Summary

Prepared by Marshall Learned

**1600 Continental**  
**1600 Continental Pl, Mount Vernon, WA, 98273**  
**Ring: 5, 10, 15 Miles**

**Latitude: 48.434833**  
**Longitude: -122.325663**

	5 miles radius	10 miles radius	15 miles radius
<b>Median Household Income</b>			
1990 Median HH Income	\$29,116	\$28,267	\$29,389
2000 Median HH Income	\$41,985	\$42,538	\$44,579
2010 Median HH Income	\$53,031	\$53,015	\$55,588
2015 Median HH Income	\$60,238	\$60,360	\$62,919
1990-2000 Annual Rate	3.73%	4.17%	4.25%
2000-2010 Annual Rate	2.3%	2.17%	2.18%
2010-2015 Annual Rate	2.58%	2.63%	2.51%
<b>Per Capita Income</b>			
1990 Per Capita Income	\$14,213	\$13,727	\$13,902
2000 Per Capita Income	\$20,313	\$20,577	\$21,380
2010 Per Capita Income	\$22,673	\$23,238	\$24,627
2015 Per Capita Income	\$26,123	\$26,879	\$28,422
1990-2000 Annual Rate	3.64%	4.13%	4.4%
2000-2010 Annual Rate	1.08%	1.19%	1.39%
2010-2015 Annual Rate	2.87%	2.95%	2.91%
<b>Average Household Income</b>			
1990 Average Household Income	\$36,421	\$35,718	\$36,207
2000 Average Household Income	\$55,275	\$55,492	\$56,508
2010 Average HH Income	\$62,629	\$62,812	\$65,148
2015 Average HH Income	\$72,372	\$72,778	\$75,265
1990-2000 Annual Rate	4.26%	4.5%	4.55%
2000-2010 Annual Rate	1.23%	1.22%	1.4%
2010-2015 Annual Rate	2.93%	2.99%	2.93%

### Households by Income

Current median household income is \$55,588 in the market area, compared to \$54,442 for all U.S. households. Median household income is projected to be \$62,919 in five years. In 2000, median household income was \$44,579, compared to \$29,389 in 1990.

Current average household income is \$65,148 in this market area, compared to \$70,173 for all U.S. households. Average household income is projected to be \$75,265 in five years. In 2000, average household income was \$56,508, compared to \$36,207 in 1990.

Current per capita income is \$24,627 in the market area, compared to the U.S. per capita income of \$26,739. The per capita income is projected to be \$28,422 in five years. In 2000, the per capita income was \$21,380, compared to \$13,902 in 1990.

### Population by Employment

Total Businesses	2,899	3,941	5,783
Total Employees	28,263	37,960	50,811

Currently, 89.3 percent of the civilian labor force in the identified market area is employed and 10.7 percent are unemployed. In comparison, 89.2 percent of the U.S. civilian labor force is employed, and 10.8 percent are unemployed. In five years the rate of employment in the market area will be 91.0 percent of the civilian labor force, and unemployment will be 9.0 percent. The percentage of the U.S. civilian labor force that will be employed in five years is 91.2 percent, and 8.8 percent will be unemployed. In 2000, 63.7 percent of the population aged 16 years or older in the market area participated in the labor force, and 1.2 percent were in the Armed Forces.

In the current year, the occupational distribution of the employed population is:

- 55.9 percent in white collar jobs (compared to 61.6 percent of U.S. employment)
- 18.7 percent in service jobs (compared to 17.3 percent of U.S. employment)
- 25.4 percent in blue collar jobs (compared to 21.1 percent of U.S. employment)

In 2000, 78.1 percent of the market area population drove alone to work, and 4.4 percent worked at home. The average travel time to work in 2000 was 25.0 minutes in the market area, compared to the U.S. average of 25.5 minutes.

### Population by Education

In 2010, the educational attainment of the population aged 25 years or older in the market area was distributed as follows:

- 12.4 percent had not earned a high school diploma (14.8 percent in the U.S.)
- 26.1 percent were high school graduates only (29.6 percent in the U.S.)
- 11.5 percent had completed an Associate degree (7.7 percent in the U.S.)
- 15.0 percent had a Bachelor's degree (17.7 percent in the U.S.)
- 8.1 percent had earned a Master's/Professional/Doctorate Degree (10.4 percent in the U.S.)

Source: U.S. Bureau of the Census, 2000 Census of Population and Housing. Esri forecasts for 2010 and 2015. Esri converted 1990 Census data into 2000 geography.